



Report No.: 3040184.00-51

Report Date: 2017-10-20

# Inspection report

Client :	Sotech International	Tel:	331 4893 9310	Fax:	331 4893 9357
Attn:	Michele BESNAINOU	Supplier:	N/A		
Inspection Date:	2017-10-19	<input type="checkbox"/> 1 <sup>st</sup> / 2 <sup>nd</sup> Re-inspection (Previous Report No.)			
Product Description:	Blender				
Manufacturer Name:	FORON INDUSTRIAL CO., LIMITED				
Manufacturer Location:	UNIT 04, 7/F BRIGHT WAY TOWER NO.33 MONG KOK, KOWLOON, HONG KONG, China				
Manufacturer Contact:	JAY				
Service Required:	<input checked="" type="checkbox"/> <b>FRI</b> (Final Random Inspection)		<input type="checkbox"/> <b>DPI</b> (During Production Inspection)		<input type="checkbox"/>

P/O No.	Item No.	Order Qty.	Shipment Qty.:	Sales destination	Carton Qty.:	Inspected Qty.	Packed CTN (%)	Product ion (%)	Sample Size
2017160	KBLI-9560 (BT-B02A)	4572pcs	4572pcs	--	1143ctns	4572pcs	100%	100%	125pcs

<b>INSPECTION RESULT:</b>	<input checked="" type="checkbox"/> <b>PASS</b> <input type="checkbox"/> <b>FAIL</b> <input type="checkbox"/> <b>PENDING</b> (if Fail or Pending) due to remarks of: .
<b>ON-SITE CC INFORMATION:</b>	<input type="checkbox"/> <b>N/A</b> <input checked="" type="checkbox"/> <b>The On-site CC for this item was performed on 2017-10-19, as per our report no. 3040184.00-50 with the result -</b> <input checked="" type="checkbox"/> <b>PASS</b> <input type="checkbox"/> <b>FAIL</b> <input type="checkbox"/> <b>PENDING</b>

A-1) : AQL and Defects Finding					
Inspection Sampling Standard Adopted: <input checked="" type="checkbox"/> ISO 2859-1			Nonconformity (defective)		
Inspection Plan:	Single sampling plans for normal inspection		Critical	Major	Minor
Inspection Level:	Fixed	AQL:	Not Allowed	2.5	4.0
Inspection with:	<input type="checkbox"/> approved sample <input type="checkbox"/> specific check list <input checked="" type="checkbox"/> general check list	Sample Size:	125	125	125
Defect Description					
Rating label was curling up.				1	
Dent mark on glass jar.					1
Scratch mark on unit body.					1
Dirty stain on housing.					3
<b>Total Found:</b>			0	1	5
<b>Max. Allowed:</b>			0	7	10

The report reflects the findings at the time and place of inspection. This report does not relieve the sellers/manufacturers from their contractual liabilities or prejudice the buyer's right for compensation for any apparent and/or hidden defects not detected during our random inspection or occurring thereafter. This report does not evidence shipment.

A-2: Remarks and Comments		
	Please confirm	Status
1	The product No.'ELO-777' printed on product and packing.	Information

A-3. Picture with description for Remarks.	
N/A	N/A
1. N/A	2. N/A

Inspected by	:	Bell Zhong	Signature	:	<i>Bell Zhong</i>
Reviewed by	:	Sanky Liu	Signature	:	<i>Sanky Liu</i>

The report reflects the findings at the time and place of inspection. This report does not relieve the sellers/manufacturers from their contractual liabilities or prejudice the buyer's right for compensation for any apparent and/or hidden defects not detected during our random inspection or occurring thereafter. This report does not evidence shipment.

**B. Quantity/Specification/Product requirement verification**

**B-1) Check inspection lot size against:**

<input checked="" type="checkbox"/> Purchase order	<input checked="" type="checkbox"/> Conformed	<input type="checkbox"/> Not conformed
<input checked="" type="checkbox"/> Inspection booking form	<input checked="" type="checkbox"/> Conformed	<input type="checkbox"/> Not conformed
<input type="checkbox"/> Packing list	<input type="checkbox"/> Conformed	<input type="checkbox"/> Not conformed

**B-2) Check product description/ colour /style against:**

<input checked="" type="checkbox"/> Purchase order	<input checked="" type="checkbox"/> Conformed	<input type="checkbox"/> Not conformed
<input type="checkbox"/> Product specification	<input type="checkbox"/> Conformed	<input type="checkbox"/> Not conformed
<input type="checkbox"/> Reference artwork	<input type="checkbox"/> Conformed	<input type="checkbox"/> Not conformed
<input type="checkbox"/> Golden sample	<input type="checkbox"/> Conformed	<input type="checkbox"/> Not conformed
<input type="checkbox"/> (others:please specify the sender and receiving date)	<input type="checkbox"/> Conformed	<input type="checkbox"/> Not conformed

**B-3) Packing material**

Export carton	New export carton	<input checked="" type="checkbox"/>
Fasting	Metal staples	<input type="checkbox"/>
Sealing	Transparent gummed tape	<input checked="" type="checkbox"/>
	Opaque gummed tape	<input type="checkbox"/>
	Paper tape	<input type="checkbox"/>
Strapping	Nylon	<input type="checkbox"/>
Material	Ply of cardboard	<input type="checkbox"/> 3ply (single wall) <input checked="" type="checkbox"/> 5ply (double wall) <input type="checkbox"/> 7ply (triple wall)
Others	Poly foam inside packing	<input type="checkbox"/> Yes <input checked="" type="checkbox"/> No

**B-4) Packaging information**

	Qty per selling unit	Carton size (cm)			N.W. (kg)	G.W. (kg)
		L(cm)	W(cm)	H(cm)		
Gift Box	1pc	23.6	18.2	31.7	3.10	3.450
Outer carton	4pcs	48.7	38.5	33.2	12.40	14.48

**B-5) Barcode check**

Overall result: <input checked="" type="checkbox"/> Pass <input type="checkbox"/> Fail <input type="checkbox"/> N/A (no barcodes were found on product or packing.)	
1.	Barcode scanning performed on (S-1) : 5pcs
2.	Barcode readability result: <input checked="" type="checkbox"/> Pass <input type="checkbox"/> Fail Barcode scanner brand and model number: HKI-136.
3.	Barcode number : <input checked="" type="checkbox"/> on gift box: 3760115715325 <input checked="" type="checkbox"/> on carton: 3760115715325
4.	Did the Barcodes on inspected samples conform to specifications/PO requirement:

The report reflects the findings at the time and place of inspection. This report does not relieve the sellers/manufacturers from their contractual liabilities or prejudice the buyer's right for compensation for any apparent and/or hidden defects not detected during our random inspection or occurring thereafter. This report does not evidence shipment.

Report No.: 3040184.00-51

Report Date: 2017-10-20

<input checked="" type="checkbox"/> Conformed	<input type="checkbox"/> Not conformed	<input type="checkbox"/> N/A
---	--	------------------------------

**B-6) Shipping marks:**

For export carton	front side marks <input checked="" type="checkbox"/>	side marks <input checked="" type="checkbox"/>
For inner box	front side marks <input type="checkbox"/>	side marks <input type="checkbox"/>

**B-7) Color / style / material Conform to Golden Sample?**

<input type="checkbox"/> Yes
<input type="checkbox"/> No, please see remark
<input checked="" type="checkbox"/> N/A, no Golden sample

**C. ON-SITE CHECKING**

Test performed	Sample size	Result	Comments
Hi-pot check	125pcs	Pass	1500V, 2S, 5mA
Earth continuity check	125pcs	Pass	12V/25A, less than 0.2ohms with power cord
Basic function check	125pcs	Pass	Switch on/off
Full function check	13pcs	Pass	According to instruction manual
Input power consumption	13pcs	Pass	215-247W at 230V 50Hz, without loading
Endurance check	5pcs	Pass	1 min. on then 30s off with water as 1 cycle, total 10 cycles (factory spec.)
Internal check	5pcs	Pass	Check internal workmanship
Power cord length measurement	5pcs	Reference	98-100cm with plug
Rub check	5pcs	Pass	Rub 15S with water & then 15S with alcohol
Tape check	5pcs	Pass	3M 810# tape
Strain relief test	5pcs	Pass	100N, 25times, Displace less than 2mm.
Application check	2pcs	Pass	Actual using
Stability check	2pcs	Pass	10° incline plate, no tip over
Critical component check	1pc	Pass	Per CDF

**D. OTHER INFORMATION**

	Please note																																								
1.	34Cartons were randomly sampled from the batch of above item subjected for inspection.																																								
2	<input checked="" type="checkbox"/> Selected carton number: <table border="1" style="margin-left: 20px;"> <tr> <td>84</td><td>48</td><td>13</td><td>757</td><td>553</td><td>1102</td><td>646</td><td>31</td></tr> <tr> <td>4</td><td>640</td><td>29</td><td>51</td><td>38</td><td>7</td><td>17</td><td>22</td></tr> <tr> <td>938</td><td>456</td><td>338</td><td>1029</td><td>329</td><td>433</td><td>101</td><td>921</td></tr> <tr> <td>883</td><td>724</td><td>218</td><td>499</td><td>1038</td><td>911</td><td>121</td><td>147</td></tr> <tr> <td>119</td><td>1123</td><td>/</td><td>/</td><td>/</td><td>/</td><td>/</td><td>/</td></tr> </table>	84	48	13	757	553	1102	646	31	4	640	29	51	38	7	17	22	938	456	338	1029	329	433	101	921	883	724	218	499	1038	911	121	147	119	1123	/	/	/	/	/	/
84	48	13	757	553	1102	646	31																																		
4	640	29	51	38	7	17	22																																		
938	456	338	1029	329	433	101	921																																		
883	724	218	499	1038	911	121	147																																		
119	1123	/	/	/	/	/	/																																		
3	<input type="checkbox"/> Carton no. was not assigned.																																								

The report reflects the findings at the time and place of inspection. This report does not relieve the sellers/manufacturers from their contractual liabilities or prejudice the buyer's right for compensation for any apparent and/or hidden defects not detected during our random inspection or occurring thereafter. This report does not evidence shipment.

**E. Critical component data**

	Component	Trade Mark	Model	Technical data	Conformity mark	Results
1.	Plug	YAN CHUANG	YC-08	250V~, 16 A	VDE	Pass
2.	Power cord	YAN CHUANG	H05VV-F	3G0,75mm <sup>2</sup>	VDE	Pass
3.	Micro switch	TMAWD	KW4A	5(2)A 250V, T125	VDE	Pass
4.	X2 Capacitor	---	MPX	275V~ 0.47uF, T110	VDE	Pass
5.	Y2 Capacitor	JEC	JY	300V 472M	VDE	Pass
6.	Motor	---	HC7635	220-240V~, 180W, Class120	Tested with appliance	Pass
7.	Thermal link in motor	--	SPF 129	AC250V; 10A; Tf133°C	Tested with appliance	Pass
8.	Selected switch	--	GZ	AC240V, 3A	Tested with appliance	Pass
9.	Internal wire	--	1015	18/22AWG, 600VAC, 105°C	Tested with appliance	Pass

Remark: Above components are tested against CDF under SGS, test report#: 1716406901

The report reflects the findings at the time and place of inspection. This report does not relieve the sellers/manufacturers from their contractual liabilities or prejudice the buyer's right for compensation for any apparent and/or hidden defects not detected during our random inspection or occurring thereafter. This report does not evidence shipment.

**F. Pictures**

	
<p>1. Goods in warehouse</p>	<p>2. Carton view</p>
	
<p>3. Shipping mark</p>	<p>4. Side mark</p>
	
<p>5. Barcode</p>	<p>6. Open carton view</p>

The report reflects the findings at the time and place of inspection. This report does not relieve the sellers/manufacturers from their contractual liabilities or prejudice the buyer's right for compensation for any apparent and/or hidden defects not detected during our random inspection or occurring thereafter. This report does not evidence shipment.



7. Gift view



8. Gift view



9. Gift view



10. Gift view



11. Barcode on gift box



12. Main feature on gift box

The report reflects the findings at the time and place of inspection. This report does not relieve the sellers/manufacturers from their contractual liabilities or prejudice the buyer's right for compensation for any apparent and/or hidden defects not detected during our random inspection or occurring thereafter. This report does not evidence shipment.



13. Main feature on gift box



14. Main feature on gift box



15. Main feature on gift box



16. Main feature on gift box



17. Main feature on gift box



18. Main feature on gift box

The report reflects the findings at the time and place of inspection. This report does not relieve the sellers/manufacturers from their contractual liabilities or prejudice the buyer's right for compensation for any apparent and/or hidden defects not detected during our random inspection or occurring thereafter. This report does not evidence shipment.



19. Main feature on gift box



20. Open gift box view



21. Unit packing view

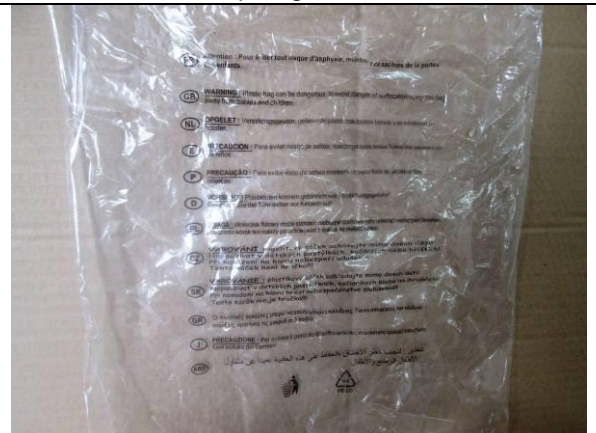

22. Warning marking



23. Unit family view



24. User manual

The report reflects the findings at the time and place of inspection. This report does not relieve the sellers/manufacturers from their contractual liabilities or prejudice the buyer's right for compensation for any apparent and/or hidden defects not detected during our random inspection or occurring thereafter. This report does not evidence shipment.



25. Warranty sheet



26. Warranty sheet



27. Unit view



28. Unit view



29. Unit view



30. Unit view

The report reflects the findings at the time and place of inspection. This report does not relieve the sellers/manufacturers from their contractual liabilities or prejudice the buyer's right for compensation for any apparent and/or hidden defects not detected during our random inspection or occurring thereafter. This report does not evidence shipment.



31. Unit view



32. Unit view



33. Unit view



34. Unit view



35. Rating label



36. Marking on unit

The report reflects the findings at the time and place of inspection. This report does not relieve the sellers/manufacturers from their contractual liabilities or prejudice the buyer's right for compensation for any apparent and/or hidden defects not detected during our random inspection or occurring thereafter. This report does not evidence shipment.



37. Logo



38. Unit detail



39. Unit detail



40. Unit detail



41. Unit detail



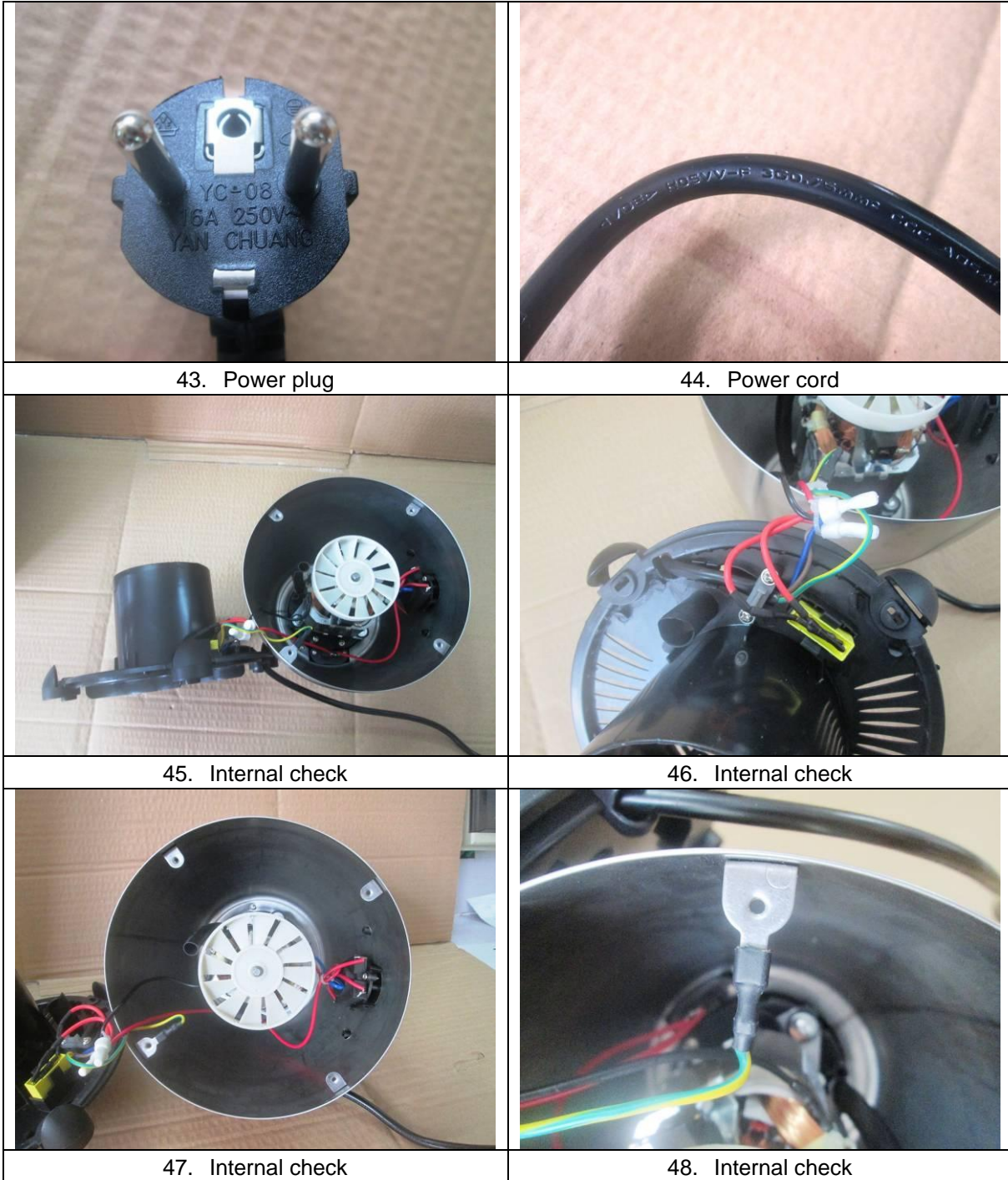

42. Unit detail

The report reflects the findings at the time and place of inspection. This report does not relieve the sellers/manufacturers from their contractual liabilities or prejudice the buyer's right for compensation for any apparent and/or hidden defects not detected during our random inspection or occurring thereafter. This report does not evidence shipment.



The report reflects the findings at the time and place of inspection. This report does not relieve the sellers/manufacturers from their contractual liabilities or prejudice the buyer's right for compensation for any apparent and/or hidden defects not detected during our random inspection or occurring thereafter. This report does not evidence shipment.

							
<p>49. Internal check</p>	<p>50. Motor</p>						
 <table border="1" data-bbox="365 871 657 1039"> <tr> <td colspan="2">HC7635</td> </tr> <tr> <td colspan="2">220V~240v50Hz180W</td> </tr> <tr> <td>Insulation Grade:</td> <td>120 (E)</td> </tr> </table>	HC7635		220V~240v50Hz180W		Insulation Grade:	120 (E)	
HC7635							
220V~240v50Hz180W							
Insulation Grade:	120 (E)						
<p>51. Motor</p>	<p>52. Y capacitor</p>						
							
<p>53. Thermal fuse</p>	<p>54. Thermal fuse</p>						

The report reflects the findings at the time and place of inspection. This report does not relieve the sellers/manufacturers from their contractual liabilities or prejudice the buyer's right for compensation for any apparent and/or hidden defects not detected during our random inspection or occurring thereafter. This report does not evidence shipment.

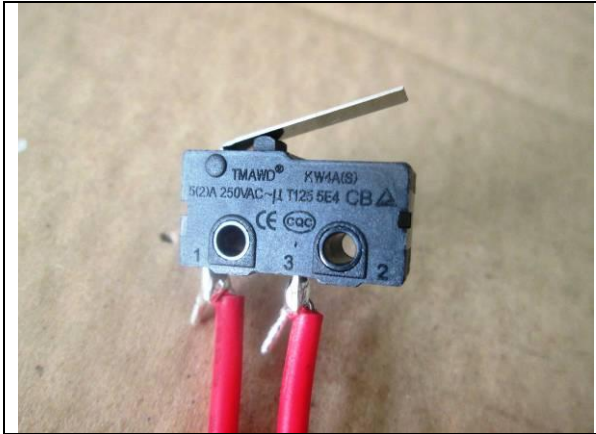

55. Interlock switch



56. Main switch



57. X2 capacitor



58. Internal wire



59. Hi-pot test



60. Earthy continuity test

The report reflects the findings at the time and place of inspection. This report does not relieve the sellers/manufacturers from their contractual liabilities or prejudice the buyer's right for compensation for any apparent and/or hidden defects not detected during our random inspection or occurring thereafter. This report does not evidence shipment.



61. Input power consumption check



62. Input power consumption check



63. Endurance test



64. Application check



65. Application check



66. Application check

The report reflects the findings at the time and place of inspection. This report does not relieve the sellers/manufacturers from their contractual liabilities or prejudice the buyer's right for compensation for any apparent and/or hidden defects not detected during our random inspection or occurring thereafter. This report does not evidence shipment.



67. Application check



68. Strain relief test



69. Stability test



70. Rub test



71. Tape test



72. Barcode scanning check

The report reflects the findings at the time and place of inspection. This report does not relieve the sellers/manufacturers from their contractual liabilities or prejudice the buyer's right for compensation for any apparent and/or hidden defects not detected during our random inspection or occurring thereafter. This report does not evidence shipment.

	
<p>73. Barcode scanning check</p>	<p>74. Power cord length check</p>
	
	<p>75. Minor-Dent mark on glass jar.</p>
	
<p>77. Minor-Scratch mark on unit housing..</p>	<p>78. Minor- Dirty stain on housing.</p>

The report reflects the findings at the time and place of inspection. This report does not relieve the sellers/manufacturers from their contractual liabilities or prejudice the buyer's right for compensation for any apparent and/or hidden defects not detected during our random inspection or occurring thereafter. This report does not evidence shipment.



79. Minor- Dirty stain on housing.

80. Minor- Dirty stain on housing.

**-END OF REPORT-**

The report reflects the findings at the time and place of inspection. This report does not relieve the sellers/manufacturers from their contractual liabilities or prejudice the buyer's right for compensation for any apparent and/or hidden defects not detected during our random inspection or occurring thereafter. This report does not evidence shipment.