

ELECTRIC ESPRESSO COFFEE MACHINE

Instruction manual



Dear consumer, please read these instructions carefully before use in order to avoid damage due to incorrect use and to better understand the functions of this product. Please pay particular attention to the safety guide. If you pass the device on to a third party, these Operating Instructions must also be handed over. Please keep them for future references.

IMPORTANT SAFEGUARDS

- ❑ Please read these instructions carefully before use.
- ❑ Keep present instructions for future references.
- ❑ Check that your mains voltage corresponds to that stated on the appliance.
- ❑ Only use the appliance for domestic purposes and household or similar applications such as:
 - staff kitchen areas, in shops, offices and other working environments;
 - By clients in hotels, motels and other residential type environments;
 - Environment type like :
 - Farm Houses • Bed and Breakfast.
- ❑ Only use the appliance in the way indicated in these instructions.
- ❑ Never use this unit near bathtub, shower, wash-hand basins or other containers with water.
- ❑ Never use this apparatus near water projections.
- ❑ Never use this apparatus with the wet hands.
- ❑ If, unfortunately the apparatus is wet, immediately withdraw the cord of the socket-outlet.
- ❑ Inform potential users of these instructions.
- ❑ Never leave the appliance unsupervised when in use.
- ❑ The appliance must be used only for its intended purpose. No responsibility can be taken for any possible damage caused by incorrect use or improper handling.
- ❑ Children and persons with disabilities are not always aware of the danger posed by the use of appliances.
- ❑ This appliance can be used by children aged from 8 years and above if they have been given supervision or instruction concerning use of the appliance in a safe way and if they understand the hazards involved.
- ❑ Cleaning and user maintenance shall not be made by

- children unless they are older than 8 and supervised.
- Keep the appliance and its cord out of reach of children aged less than 8 years.
 - Appliances can be used by persons with reduced physical, sensory or mental capabilities or lack of experience and knowledge if they have been given supervision or instruction concerning use of the appliance in a safe way and understand the hazards involved.
 - Children shall not play with the appliance.
 - **WARNING:** The filling aperture must not be opened during use.
 - In order to ensure your children's safety, please keep all packaging (plastic bags, boxes, polystyrene etc.) out of their reach.
 - **Caution!** Do not allow small children to play with the foil.

THERE IS A DANGER OF SUFFOCATION!

- From time to time check the cord for damages. Never use the appliance if cord or appliance shows any signs of damage.
- Never immerse the appliance in water or any other liquid for any reason whatsoever.
- Never place it into the dishwasher.
- Never use the appliance near hot surfaces.
- Do not operate the appliance with a damaged cord or plug, or after the appliance has been damaged in any manner.
- If the supply cord or appliance is damaged, it must be replaced by the manufacturer or its service agent or a similarly qualified person in order to avoid a hazard.
- Disconnect the power source cable before any operation of cleaning of maintenance and accessories assembly.
- Never use the appliance outside and always place it in a dry environment.

- ❑ Never use accessories, which are not recommended by the producer. They could constitute a danger to the user and risk to damage the appliance.
- ❑ Never use any other connector than the one provided.
- ❑ Never move the appliance by pulling the cord. Make sure the cord cannot get caught in any way.
- ❑ Never wind the cord around the appliance and do not bend it
- ❑ Ensure that the power cord does not come into contact with hot parts of this unit.
- ❑ Make sure the appliance has cooled down before cleaning and storing it.
- ❑ The temperature of accessible surfaces may be very high when the appliance is operating. Never touch these parts, of apparatus, to avoid burning itself.
- ❑ Make sure the appliance never comes into contact with flammable materials, such as curtains, cloth, etc...& the power cord and plug do not come in contact with water.
- ❑ Before cleaning, always unplug the appliance from the power supply and let it cool down.
- ❑ This appliance is not intended to be operated by means of an external timer or separate remote-control system.
- ❑ Always place the unit on a flat surface. Ensure, also, not to cover the device and not to put anything on it.
- ❑ Always remove the plug from the wall socket when the appliance is not in use.
- ❑ When using an extension lead always make sure that the entire cable is unwound from the reel. Use solely CE approved extension leads. Input power must be at least 16A, 250V, 3000W.
- ❑ Incorrect operation and improper use can damage the appliance and cause injury to the user.
- ❑ This device, designed for home use, complies with standards relating to this type of product.
- ❑ The appliance must be used and rested on a table or flat & stable surface.

- The item must not be left unattended when it is connected to main supply.
- The item is not to be used, if it has been dropped or if there are visible signs of damage or if it is leaking.
- Regarding the instructions for cleaning, thanks to refer to the below paragraph of the manual.
- This appliance is only intended for household use.
- Warning: avoid spillage on the connector.
- Warning: potential injury from misuse.
- The heating element surface is subject to residual heat after use.

(*) **Competent qualified person** : after sales department of the producer or importer or any person who is qualified, approved and competent to perform this kind of repairs.

GENERAL INFORMATION

The symbol "OPEN BOOK" means a recommendation to read important things contained in the record.

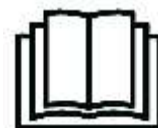

The symbol "BIN" crossed out, abbreviation WEEE (Waste of Electrical and Electronic Equipment) means that at the end of life, it should not be discarded with household waste, but filed to the sorting of the locality. Waste recovery can help preserve our environment.



The symbol "STEAM" warns the user that steam can escape from the unit and to take all necessary precautions. (Risk of burns)



The symbol "CE" is the guarantee of compliance with harmonized European standards, voluntary, reflecting the essential requirements into technical specifications. These standards are not mandatory



but are guarantees of compliance with essential requirements.

The symbol "GLASS / FORK" means that the device is compatible and can come into contact with foodstuffs.



The symbol ROHS (Restriction of use of some Hazardous Substances) on the Environmental Protection, certifies that for each of the five hazardous substances • Lead • Mercury • (hexavalent) chromium • products for protection against flames PBB and PBDE, the peak concentration is equal to or less than 0.1% of the weight of homogeneous material, and 0.01% for the 6th • cadmium.



The symbol "TRIMAN" indicates that the consumer is invited to dispose the product as part of a separate collection (eg recycling bin, waste, voluntary intake point).



The symbol "CMIM marking" is the guarantee of compliance with the harmonized Moroccan Standards, optional, which translate the essential requirements into technical specifications. These standards are not mandatory but guarantee compliance with the essential requirements.



For more information : <http://www.quefairedemesdechets.fr>

TO KNOW ITS UNIT



1. Control panel and functions
2. Dry tray cups
3. Water tank
4. Steam production control
5. Steam tube handle

6. Steam tube
7. Coffee maker base
8. Removable grid
9. Filter holder
10. Filter Inserting Hole

1. Light indicator
2. 1 cup selector
3. 2 cups selector
4. M / A switch
5. Manual selector (amount of water)
6. Steam production key



WATER / STEAM CONTROL

0 = Closed command

= Water command
or Steam

- => + To more water or steam.



FIRST USE

Before first use, remove the device and all accessories.

- Clean the apparatus according to the instructions in "Cleaning and

Maintenance" paragraph.

- Place the machine on a suitable flat, stable surface.
- Unroll the power cord completely.
- Check that the tension in force in the country where you are, corresponds to that indicated on the apparatus.
- Connect the apparatus in a correct socket-outlet, (and connected to the ground if the unit is Class I), to avoid any danger.
- Disconnect the power source cable before any operation of cleaning of maintenance and accessories assembly.
- Never modify the appliance in anyway.

Before making the first cup of coffee, it is best to rinse the coffee machine with hot water.

1. Open the tank lid.
2. Pour water into the water tank.
3. Close the lid of the water tank.

Note : The water level must not exceed the "MAX" mark on the tank.

Note : Make sure the steam control knob is at "0".

4. Insert one of the 3 metal filters (1 cup, 2 cups or pod) into the filter holder.

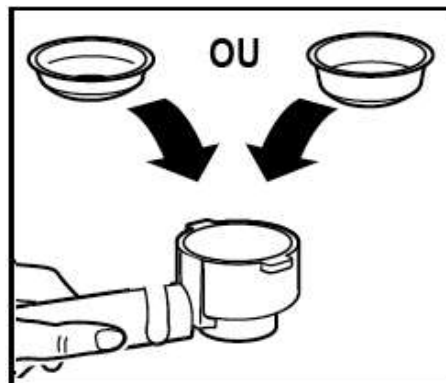

DO NOT PUT COFFE IN THE FILTER



Place the filter holder in the place provided by inserting it upwards (1). Turn right until blocking (2).

Place a cup under the filter holder.

Note : The appliance is delivered without cup or bowl. Use your own equipment, a bowl or a coffee cup.

Connect the device to the mains.

Note : The steam control (4) must be in the "0" position

Press the On / Off switch. => The indicator light flashes blue.

Press the "manual control" button and the water pump will turn on, introducing the water from the water tank into the machine, to be heated.

The unit starts to heat up.

Note : At this point, the indicator light is still flashing. Wait until the pilot light is on continuously. This will mean that preheating is completed.

It will take about 2 minutes.

Press the "1 cup" or "2 cups" button. The machine will produce hot water, which will wash the circuit and the filter.

Note : The pump will make a little noise at start-up which is normal because it removes air remaining in the device. After about 20 seconds, the noise will disappear.

USE

Unwind the power cord completely.

Check that the voltage in the country where you are, corresponds to that indicated on the device.

Plug the unit into a good electrical outlet, (earthed if the device is class I), to avoid danger.

Disconnect the power cable from the power supply before performing maintenance cleaning and accessory mounting.

Never modify the device.

Place a filter in the filter holder.

While the machine is preheating, pour coffee powder into the filter and pack the coffee with the tail of the "dozer / packer" accessory. (Coffee powder should not be ground, too big, or too thin).

Note: If necessary, clean the edge of the filter if there is some coffee powder.

Insert and lock the filter holder as indicated above, and place a coffee cup under the filter holder.

Press the "one cup", "2 cups" or "manual control" button.

The machine is working and the coffee is filling the cup.

Note : By pressing the "manual control" button it is necessary to press the same control button again to stop the coffee from running.

MAKE A CAPPUCCINO OR MILK FOAM

Method

To get a cup of cappuccino, cover the surface of the coffee with milk froth.

1. First prepare the espresso with a cup large enough to support the addition of milk froth.

2. Press the "steam control" button and the indicator light flashes red. Wait for the light to come on continuously, preheating is completed.

3. Fill 1/3 cup of whole milk.

4. Insert the steam nozzle 1 to 2 cm into the milk.

Note : always release some pressure before frothing milk.

5. Slowly turn the steam knob counter-clockwise (to the left) until the steam starts to come out. Move the container slightly up and down, turning.

Notes : It is recommended to use whole milk cooled to the temperature of fridge. (Never use hot milk !).

In choosing the pot size, it is recommended to use a diameter container greater than 70 mm, and to keep in mind that double milk of volume by becoming a froth of milk.

Make sure the height of the pot is big enough.

Never turn the steam control knob quickly because the water vapour can come out quickly and increase the risk of splashes.

6. When the milk froth is formed, turn the steam control knob to "0" clockwise (to the right).

7. Press the "steam control" button again. The indicator light turns blue.

Note : It is also possible to press the on / off button to turn off the machine.

8. Gently pour the emulsified milk onto the already prepared espresso.

- Sweeten if necessary.
- Sprinkle some cocoa powder on the frothed milk.
- The cappuccino is ready.

9. Set the selector to the "0" position to stop the steam and push on the on / off switch to stop the espresso machine.

Notes : Clean the tube of the steam nozzle, with a damp sponge, immediately after use because the milk sticks on the tube.

Finally, spray with steam to prevent the hole inside the nozzle is clogged after drying milk.

Be careful not to get hurt because the tube stays very hot for a long time. We recommend letting the machine cool down, for at least 5 minutes, before making an espresso again. Otherwise a smell of burned can occur in your espresso.

PRODUCE STEAM TO HEAT LIQUIDS

The steam nozzle (without the foaming device) can be used to make hot drinks such as hot chocolate, water or tea.

Method

1. Open the tank lid,
2. Fill with the desired amount of water.

the water level must not exceed the "MAX" mark of the tank.

3. Close the lid.
4. Connect the unit to a power source.
5. Push on the On / Off switch.

The blue LED lights up and flashes.

6. Press the "steam control" button and the indicator light flashes red. Wait for the light to come on continuously, preheating is completed.
7. Immerse the steam nozzle in the liquid to be heated.
8. Slowly turn the steam control knob counter-clockwise (to the left), steam will go out of the steam nozzle.
9. When the liquid reaches the desired temperature, turn the steam control knob to "0" clockwise (to the right).
10. Push again on the On / Off switch, to stop the coffee machine.

PRODUCE HOT WATER FOR BEVERAGE

1. Press the On / Off switch. => The indicator light flashes blue.
 2. Wait until the indicator lights up continuously, preheating is completed.
- Note: Do not press the "Steam Control" button !!!**
3. Slowly turn the steam control knob counter-clockwise (to the left) until water flows from the nozzle. Water can be used to drink, clean or warm cups.
 4. After use, turn the knob to the "0" position and press the on / off button again to turn off the machine

CLEANING AND MAINTENANCE

Before cleaning, always switch off the appliance, disconnect the apparatus and let it cool.

Clean the outside of the apparatus with a sponge or slightly wet linen.

The parts (removable) in contact with food like plate, bowl, forks, Spatula etc. can be washed in hot water with sponge and soft detergent or put in the dishwasher.

Never plunge the apparatus in water or all other liquid!

Do not use abrasive cleaners, gritting, or metal brush or another cutting object.

- Do not place any other parts of your coffee machine in the dishwasher.
- Remove the filter holder from the machine by turning it counter-clockwise,
- After every use, empty the coffee grounds left inside the filter and clean it carefully.
- Dry all accessories.

CLEANING MINERAL DEPOSITS

To ensure your coffee to work effectively, you need to clean the interior pipe; Every 2 or 3 months, From Mineral deposits left, to maintain the flavour and aroma of the coffee.

Method

Fill the tank with water at MAX level with descaling agent (The Water / descaling ratio is normally 4/1), refer to the instructions of the used descaling agent.

Use the preheat program.

Put the filter + filter holder (without coffee powder) in place and a large container under the filter holder.

1. Connect the device to the mains.

Note : The steam selector should be in the "0" position

2. Press the On / Off switch. => The indicator light flashes blue.

Note: Do not press the "Steam Control" button !!!

3. Wait until the blue light is steady.

4. Make the equivalent of 2 large cups of coffee by pressing the "manual control" button. Press the button again at the end of cleaning.

5. Turn the "Water / Steam" control knob and allow water to escape for 2 minutes.

6. Turn the "Water / Steam" control knob to "0" to stop running the water.

7. Let the descaling agent work for at least 15 minutes.

8. Restart the unit and repeat the previous steps at least 3 times.

9. Set the "Water / Steam" switch to the "+" position to empty the remaining descaling agent.

10. Fill the water tank with clear water.

The water level must not exceed the "MAX" mark in the tank.

11. Repeat above steps from 2 to 5. Then steps 6 to 9 at least 3 times each.

This is to ensure the cleanliness of the piping.

STORAGE

-Ensure the unit is completely cool and dry.

-Do not wrap the cord around the appliance, as this will cause damage.

-Keep the appliance in a cool, dry place and out of reach from children.

GUARANTEE

Before being delivered, all our products are subjected to a rigorous control.

This apparatus is guaranteed 24 months starting from the date of purchase by the consumer.

The documents in proof of guarantee are:

- The invoice and
- The filled and stamped warranty plate (located on side or bottom of the gift box). Without these documents in proof, no free replacement, nor no free repair, can be carried out.

During the warranty period, we deal for free, the defects of the apparatus or the accessories, rising from a defect of materials or manufacture by repair or,

replacement. The services within the framework of the guarantee do not involve any extension of the warranty period and does not give right to a new guarantee! In the event of recourse to the guarantee, bring back the complete apparatus to your retailer, in its original packing, accompanied by the proofs of purchase. The breakage of parts out of glass or plastic is, in all the cases, not warranted. Defects on the accessories or the wearing parts (for example: coals of engines, hooks, drive belts, remote control of replacement, teeth brushes of replacement, webs etc) as well as cleaning, maintenance or it replacement of wearing parts are not guaranteed and are thus to pay! In the event of foreign intervention, the guarantee becomes null and void. After flow of the warranty period, repairs can be carried out, against payment, by a specialized trade or a repair service.

SPECIFICATIONS

Power supply	220-240V~ 50/60Hz
Power	850W
Norm	Class I

Made in PRC

The characteristics can change without prior notice.

EARTHING

This unit is equipped with an electrical outlet with earth and must be earthed in an according plug.

Note: In the event of question concerning the earth or electric connection, please consult a qualified personnel.

In the event of short-circuit, earthing reduces the risk of electric shock while making possible the current to be evacuated by the wire of ground.

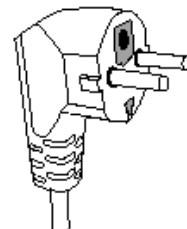

CAUTION: In order to minimize the risks of electric shock, In the event of breakdown, not to open the case but to call upon a qualified technician for repairs.

This device complies with EC directives, it was controlled according to all current European directives, applicable such as: electromagnetic compatibility (EMC) and low voltage (LVD).

This device has been designed and manufactured in compliance with the latest regulations and technical requirements for safety.

**Imported by Sotech International
" LE PERIPOLE " N°A-107
33, Avenue du Marechal de Lattre de Tassigny**

94120 Fontenay sous-bois - France